

Inverter Series:

On-Grid Monophase

Inverter Installation and
commissioning manual (software)

Manual de instalare si punere in
functiune a invertorului (software)



Introduction

Please read the manual before installing and operating the inverter.

This user manual introduces the inverter in terms of its installation, and software configuration. Please read through the manual carefully before installing and using the inverter, and keep the manual well for future reference

About This Manual

This user manual is intended for photovoltaic (PV) inverter operating personnel and qualified electrical technicians.

A. Local Initialization

IF NECESSARY:

- The installation firm needs to contact nJoy for creating a personalized account that allows for better management of the installation sites. This account will be assigned to the firm, not on the individual person.
- Download the SolarTouch app on a smartphone. (The QR code can be found on the product label).

1

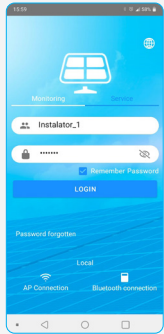

Launch the SolarTouch app and connect the device to Bluetooth (when launching the app will ask permission to access Bluetooth and GPS, please allow).

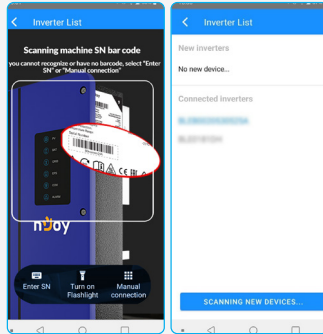

To successfully connect the inverter serial number needs to be added, by scanning or by manual adding and selecting the inverter's name from the available Bluetooth connections. (The Product serial number can be found on the side label attached to the inverter).

2

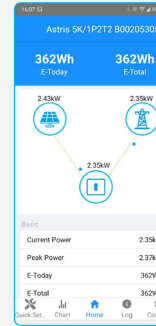

You will land on the Homepage where the inverter's functioning is already displayed.

Access Settings by clicking on Console.

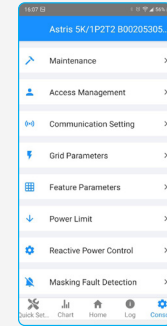

3

2

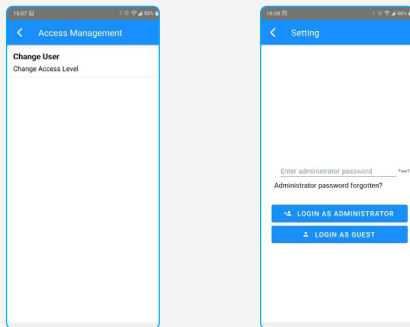

Choose the Access Management option. Access Change User and login as administrator by entering the 'admin' password.

NOTE! From this point on, the administrator account remains active. To deactivate the account it is necessary to switch to the login as a guest option. This switch will change the inverter parameters to be only viewed and not modified.

3

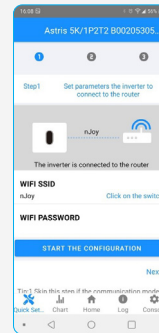

To configure the Wi-Fi module press Quick Setup from the down-left ribbon on the screen. Follow the instructions that are presented in the previous 3 steps configuration. To do this, enter the instructions details of the owner (SSID and password). Watch as the color of the LED changes from blue to green as the module connects to the Wi-Fi.

4

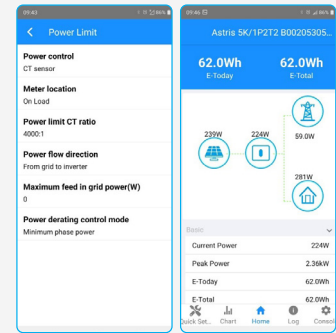

Access Console > Power Limit and set up the parameters according to the owners' system. (For example, if a CT or Smart Meter is added, make sure to set up those parameters).

NOTE! For an accurate electrical consumption reading please install the CT/Smart Meter on load (please consult the hardware installation manual).

To do other configurations, please do them here in the Console menu. After finishing, relaunch the app and verify if all settings are correct.

B. Owner's account for continuous monitoring

Our recommendation is that at every inverter commissioning attach an owner's account for monitoring the installation site and equipment and for a clear overview of all equipment commissioning. If needed, the installer firm, through the installer's account, can make a virtual, remote troubleshooting and error correction.

NOTE! During this operation a Internet connection is necessary.

1

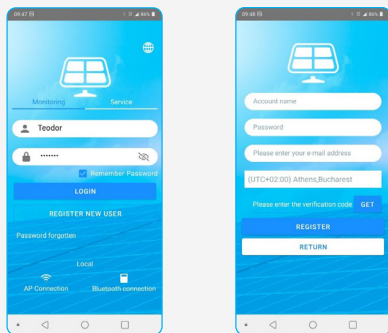

Open the app, and select REGISTER NEW USER to create a new account. With the owner, choose an account name, a password, an email address and the timezone (+2 GMT for Romania). Press GET to receive a confirmation code (on the owner's email address). Insert the verification code and press REGISTER. From this moment on the account is active.

6

2

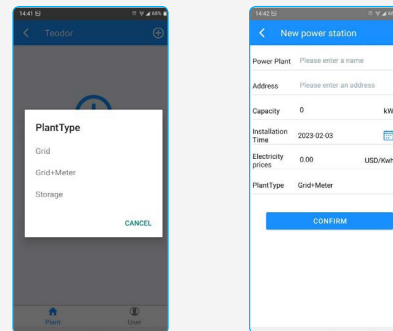

Now choose the inverter type: On Grid, On Grid with CT or Smart Meter or Hybrid. After making the selection, please fill in the following fields: Name, address, installed power (kW), installation date, the price of electrical energy (kWh). If the data is correct press CONFIRM.

7

3

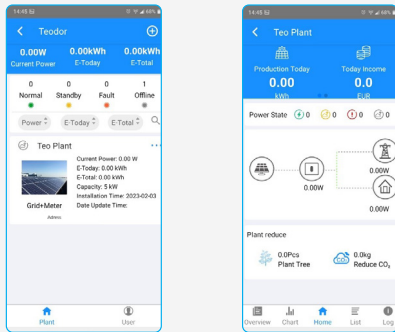

After CONFIRM, you'll see the owner's sites (represented in the images is only 1 site). Please select the desired site to access the monitoring screen (Homepage). Here can be observed the energy yield from the solar system to loads and/or electrical grid. For the moment all values are 0 because there is no installed equipment. To see a list of all inverters that have been installed, press List.

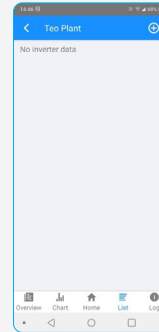

For now, the inverter list is empty. To add a new inverter to the list press + on the upper-right side of the screen.

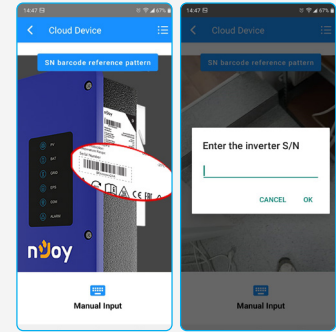

To add the inverter, the app will require the inverter S/N (Serial Number). This number can be achieved by simply scanning the side label or by manually entering (by pressing Manual Input on the bottom page) the numbers/letters.

6

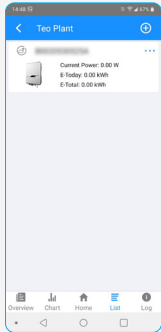

If this S/N is correct the app will automatically detect the inverter and will be added to the list.

NOTE! If the inverter is already in another location or client, the serial number will be null. For this situation please contact nJoy Technical Support.

7

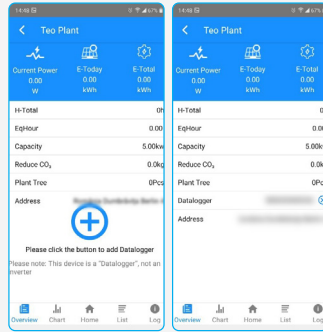

If the inverter has an attached Smart meter of CT, then the inverter serial number will be needed in the Overview screen.

Press Overview and then press the blue button +. Add the inverter serial number. From this moment on, the inverter is fully configured and the commission will be finalized. The app will receive all the relevant data about the solar system, as power yield, production and distribution modes.

8



By pressing the Home button you can see how the electricity is distributed.

NOTE! Please be aware that the refresh rate is at 5-10 minute, the data displayed is not real-time. Please allow some time for the app to refresh the data and upgrade to the latest version.

If an 1 appears on the green icon this means that the inverter is online and producing energy.

C. Adding the user account to the service application

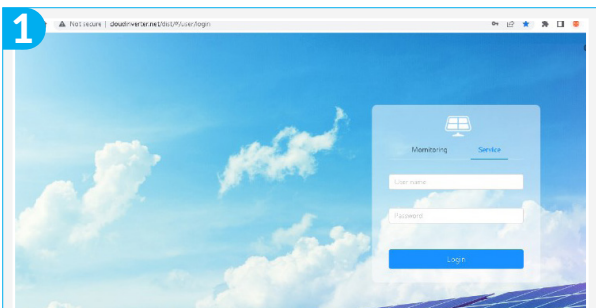

Open the browser and search www.cloudinverter.net

The Starting page of the service application will be displayed.

Select the Service version and fill the installer name and the password provided by nJoy.

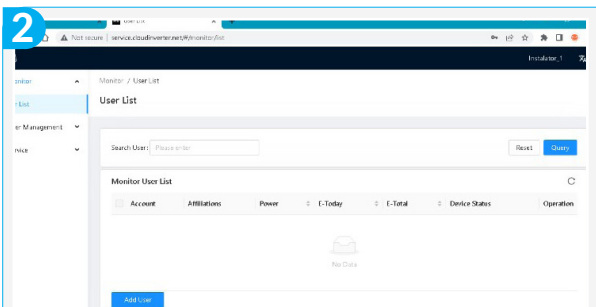

Once the installer account is accessed, the option of remote monitoring and troubleshooting becomes active. In order to do that, the owner's account needs to be added to the User List. Add a user by clicking the button.

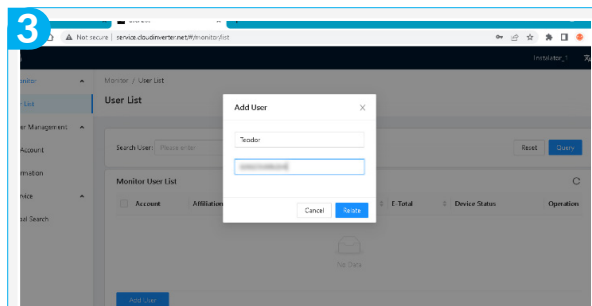

In the pop-up window you will have to fill in the owner name and inverter serial number. After making sure that the data is correct click Relate.

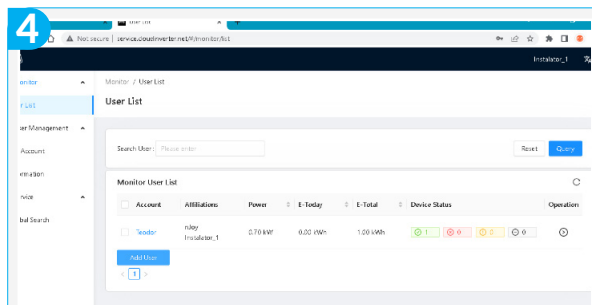

The owner account will be added to the User List. You can now see the system status (online, offline, error etc), the power generated from the PV panels, the daily yield or total yield etc.

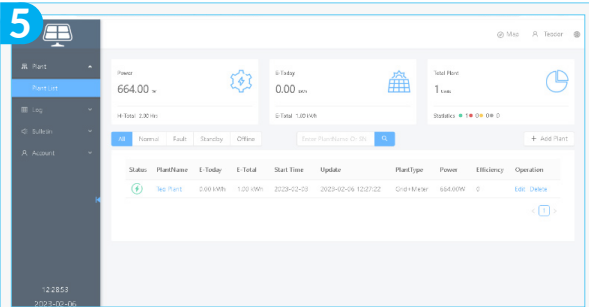

By clicking on the blue account name, a new tab will open with the user account monetization data. Here can be seen details about the installed system, the location etc.

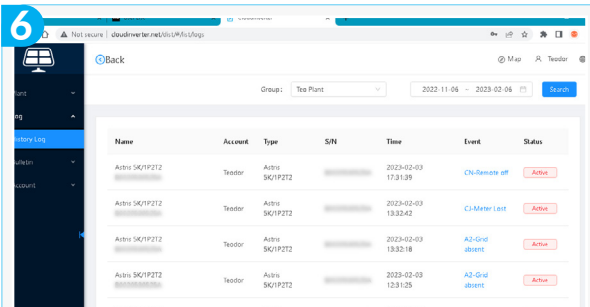

By clicking on LOG > HISTORY LOG from the owner's account, all events will be displayed such as inverter function, notifications, errors etc.

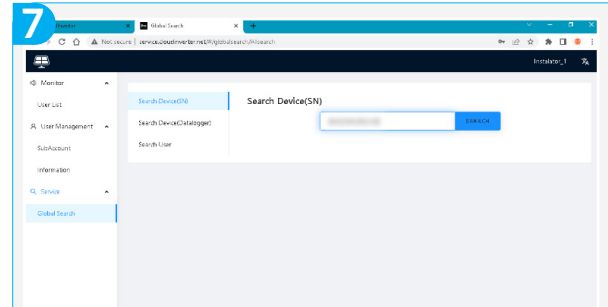

From the Service > Global search menu you can search inverters. by S/N.

NOTE! In order to find a specific equipment, it needs to be linked to an owner account and this account to be added to the installer service application.

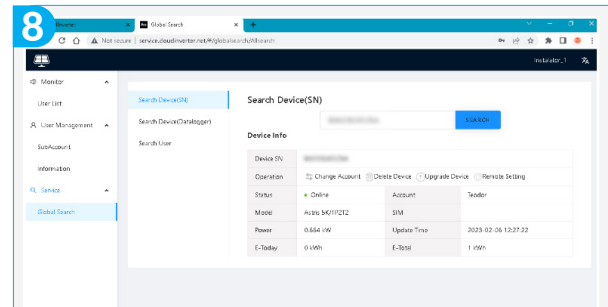

If the equipment is found, all data available will be displayed (model name, rated power, current status, owner's account linked etc).

Several actions are available, accessible from the Operation line.

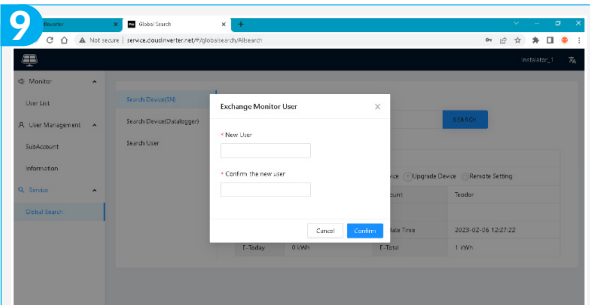

By clicking CHANGE ACCOUNT this equipment can be transferred to another owner by updating the account with the relevant information and added to the Service area of the app. The DELETE DEVICE button allows for the equipment to be erased from the owner's account.

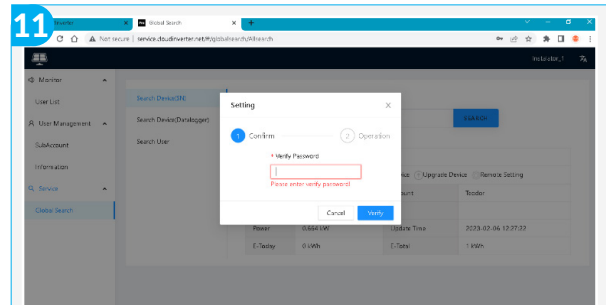

The REMOTE SETTING button allows for modification of the parameters and settings of the inverter. To have access to these parameters modifications you'll need the admin password and click Verify.

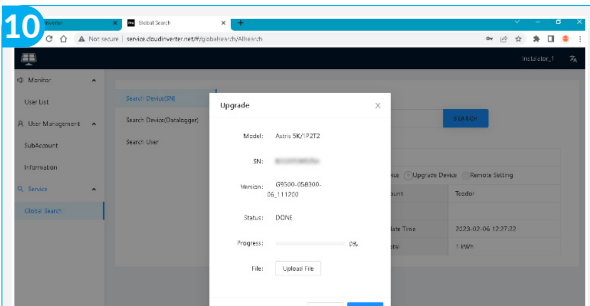

By clicking UPGRADE DEVICE the firmware can be remotely updated.

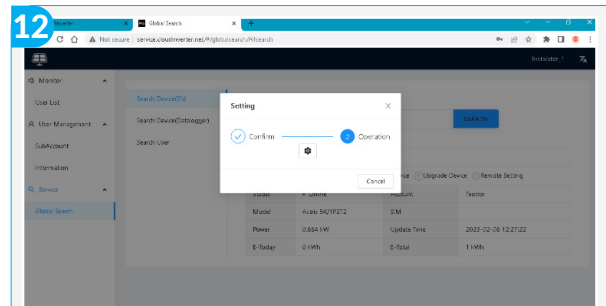

If the password is correct, a Settings symbol will appear (a gear wheel). By clicking this symbol you will have access to settings and parameters.